

TRANS^{PRO} PLUS **HOBBY**

HEAT PRESS USER'S GUIDE

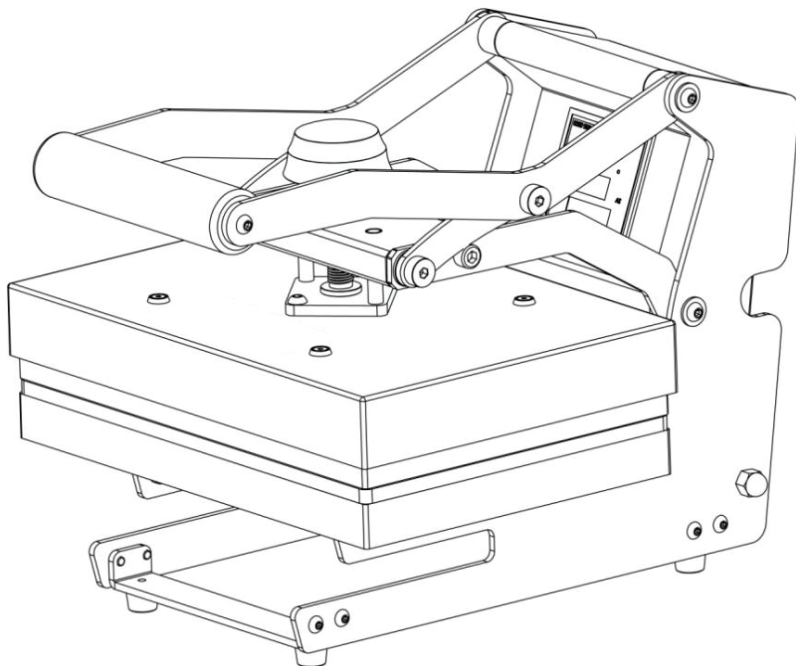

PRO WORLD[®]

HEAT APPLIED GRAPHICS • PRESSES • ACCESSORIES

www.ProWorldInc.com

Pro World Inc.
961 Bethel Ave.
Pennsauken, NJ 08110



Toll Free 800-678-8289
Outside U.S. 856-406-1020
Fax 856-406-1025

TECHNICAL PARAMETERS & OPERATION INSTRUCTIONS



1. Technical Parameters

- | | |
|--------------------------------|------------------------------|
| 1. Model NO: MP351 | 6. Power: 700W |
| 2. Machine Size: L47*W23*H39cm | 7. Time Range: 0~999S |
| 3. Heater Size: 9"*12" | 8. Maximum Temp: 221°C/430°F |
| 4. Lower Platen Size: 9"*12" | 9. Packing Size: 46*38*35cm |
| 5. Voltage: 220V/110V | 10. Gross Weight: 14kg |



2. Temperature & Time Setting

		
<p>Turn on power switch, control board shows as picture.</p>	<p>Press SET button first time, the PV part shows "sp". Press arrows "△" or "▽" to set temperature.</p>	<p>Press SET button second time, the PV part shows "st". Press arrows "△" or "▽" to set time.</p>

3. Celsius (°C) & Fahrenheit (°F) Settings

		
<p>Press "△" and "▽" once time, control board shows as picture.</p>	<p>Press "△" to input 88 as picture</p>	<p>Press SET button to enter into next interface, then press SET to choose the "ctr" interface as picture, press "△" and "▽" to change "SV" no as 0 (for Celsius) or 1 (for Fahrenheit). press SET 4 seconds to quit.</p>

4. Temperature Compensation Setting

	
<p>press SET button 4 seconds to enter into interface as picture.</p>	<p>press SET to choose "pb" interface as picture, then Press "△" and "▽" to set temperature compensation numbers. For example, if the real temperature is 15 °C higher than control board shows, pls input +15 into the AV part, if the real temperature is 15°C lower than control board shows, pls input -15 into the AV part. press SET 4 seconds to quit.</p>

WIRING SCHEMATIC

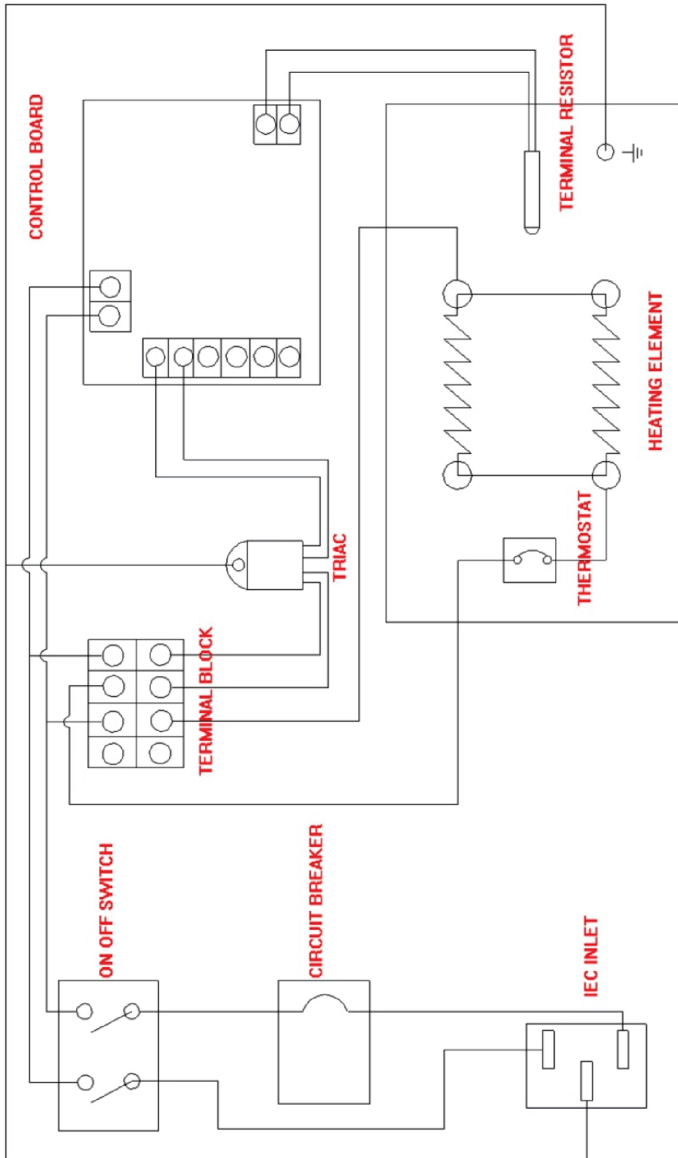

TRANSPRO WARRANTY

Warranty Coverage

TransPro products offered by Pro World are warranted against defects in material and workmanship. Warranty is void if equipment has been damaged by accident, unreasonable use, neglect, unauthorized and/or improper service, or other causes not arising out of defects in material and workmanship. This warranty does not cover damage caused by normal wear and tear, neglect or lack of proper maintenance. This warranty is for the original purchaser/owner only, it is not transferable.

Warranty Duration

The heating element shall be warranted for the life of the heat press. There is a one (1) year warranty on major components, circuit boards and all other components.

Warranty Performance

During the warranty period, and in the event that a situation cannot be resolved by telephone/email and upon PRE-AUTHORIZATION from Pro World equipment must be shipped, freight prepaid to Pro World for service in the original packaging. After 30 days, all shipping and insurance expenses to and from Pro World of in-warranty equipment is solely the responsibility of the customer. Prior to 30 days the shipping costs will be refunded if Pro World deems the equipment to be defective as stated. Pro World cannot be held responsible for improper handling or any other damage incurred in transit. No charge will be made for labor and components for repair of in-warranty equipment. OUT-OF WARRANTY machines will be charged at the repair rates in effect at the time the machine is received.

Warranty Disclaimers

Pro World shall not be liable for loss of use of TransPro equipment or other incidental or consequential costs, expenses, or damages incurred by the original purchaser or any other user. The above warranty provisions constitute the entire agreement between all parties, and supersede any and all prior written and/or oral representations and understandings.

This "Limited Warranty" applies to all TransPro equipment. However, the procedure for obtaining service may vary outside the continental United States. Contact your Pro World representative for warranty information. The purchaser is responsible for compliance with all local laws, regulations and measure. Agreement shall be governed by and construed in accordance with all applicable laws of said region.



www.ProWorldInc.com

**Pro World Inc.
961 Bethel Ave.
Pennsauken, NJ 08110**

**Toll Free 800-678-8289
Outside U.S. 856-406-1020
Fax 856-406-1025**