

TRANSPRO[®] PLUS CAP

HEAT PRESS USER'S GUIDE

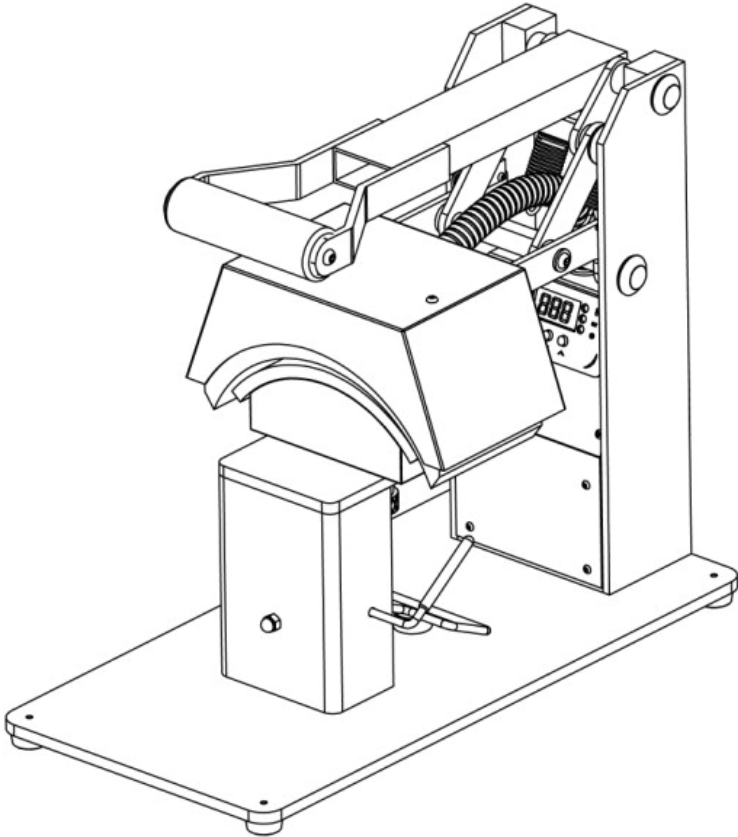

PRO[®] WORLD
HEAT APPLIED GRAPHICS • PRESSES • ACCESSORIES

www.ProWorldInc.com

Pro World Inc.
961 Bethel Ave.
Pennsauken, NJ 08110

Toll Free 800-678-8289
Outside U.S. 856-406-1020
Fax 856-406-1025

OPERATION INSTRUCTIONS

1. Connecting the System

1.1 Connect the power cord into a properly grounded electrical outlet with a sufficient amperage rating.

1.2 VOLTAGE: 120 Volt – The GS-601 requires a full 20 amp grounded circuit for 120 volt operation. 240 Volt –The GS-601 requires a full 10 amp grounded circuit for 240 volt operation.

1.3 EXTENSION CORDS: If used, should be as short as possible and not less than 12 gauge. Heavy duty cords are recommended.

1.4 CIRCUITS: that have less than 15 amps or that have other high demand equipment or appliances (especially more than one heat seal machine) plugged in, should not be used.

CAUTION: Failure to follow these instructions will cause:

1. Erratic controller functions.
2. Inaccurate displays & slow heat-up.
3. The circuit breaker to disengage.

NOTE: If the supply cord is damaged, it must be replaced by the manufacturer, its service agent or a similarly qualified person in order to avoid hazard.

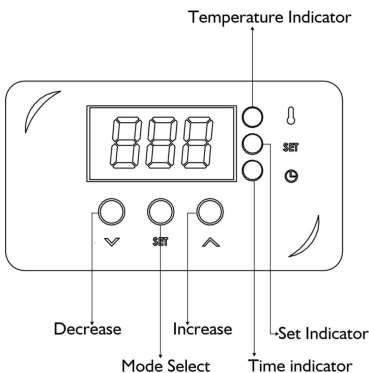

2. Turn On The System

2.1 Switch The System On

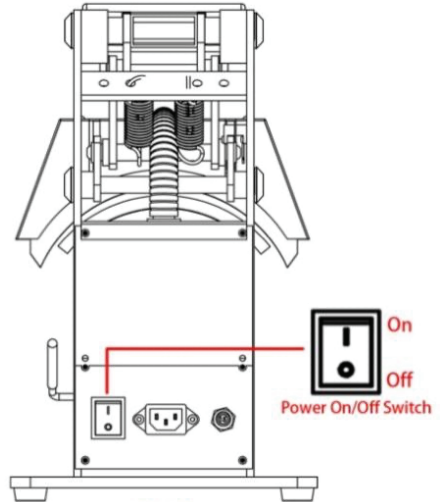

3. Adjusting The Temperature

3.1 Press the Mode Select button located in the center of the Control Panel.

"Temp" lights and "set" lights located in the display will illuminate indicating you are in the adjust temperature mode.

3.2 Next, press the (-) button located to the bottom of the Mode Select button to lower the temperature setting, or press the (+) button located to top of the Mode Select button to raise the temperature setting. The temperature can be set from 0° F (0° C) to 430° F (221° C).

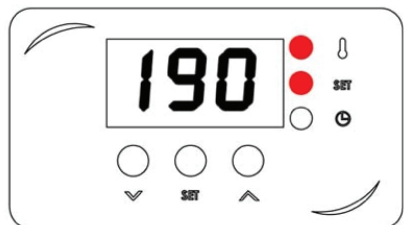

4. Adjusting The Time

4.1 Once you have adjusted the temperature, press the Mode Select button again. "Time" lights and "set" lights located in the display will illuminate indicating you are in the adjust time mode.

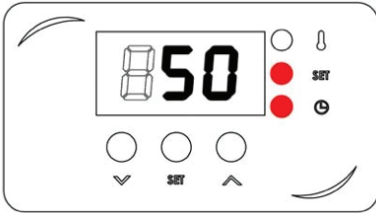

4.2 Next, press the (-) button located to the bottom of the Mode Select button to lower the value ,or press the (+) button located to top of the Mode Select button to raise the time value .The time setting range can be set from 0~999.

5. Adjusting the Pressure

5.1 The Pressure Adjustment Knob is located in the bottom of the lower platen

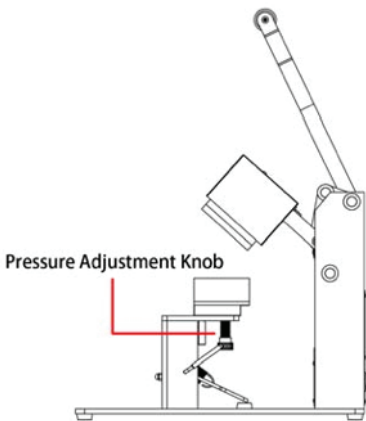

5.2 Adjust the pressure by turning the knob clockwise to increase pressure and counter clockwise to decrease pressure.

REMEMBER: To allow for the thickness of your garment when adjusting the pressure.

6. Printing And Pressing

• Once your equipment has reached the designated temperature:

• Position the garment and application and proceed to press.Lower and lock the heat platen into the press position.

• This procedure will start the automatic timing

• The timer will automatically count down circuit board will alarm when the press cycle is complete.

• The time will automatically re-set and you are ready to continue with the next application.

7. Changing From Fahrenheit To Celsius

7.1 Press and hold "down" and "up" button then press "set" button,display shows LCK

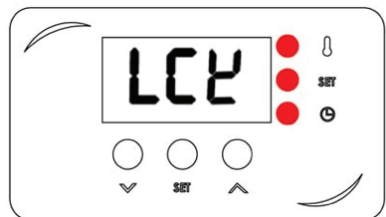

7.2 Input 68 to enter into second level menu

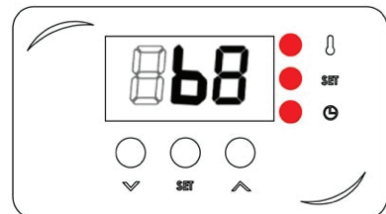

7.3 Press "set" button to select "F-C" mode (see image below), press "set" button to enter then press "up" and "down" button to set F or C, C for celsius, F for Fahrenheit

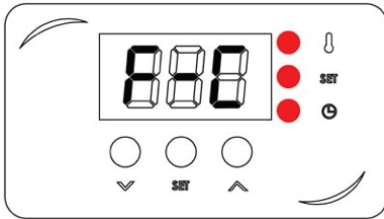

7.4 After setting, press "set" button 4 seconds to quit.

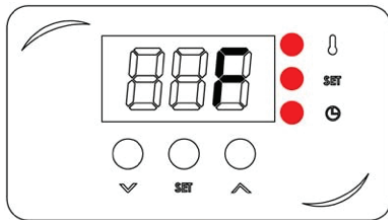

8.3 Press "set" button to select "Pb" mode press up and down button to make temperature calibration. (see 8.4)

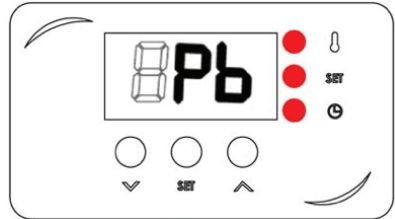

8.4 Press "set" button for 4 seconds to quit.

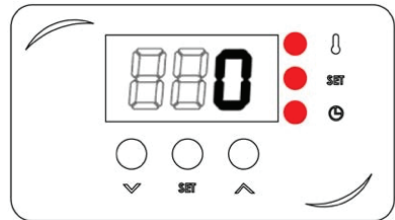

8. Temperature Calibration

8.1 Press and hold "(-)" and "(+)" button then press "set" button, display shows LCK

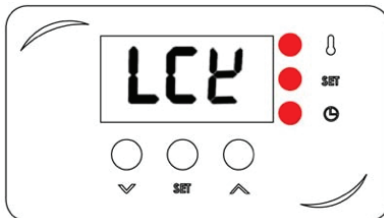

8.2 Input 68 to enter into second level menu

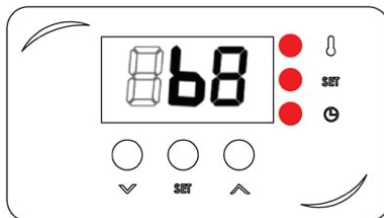

Technical Parameters

Model:	MP353
Lower Platen Size:	3.5"*6.5" (with machine) 3"*5.75" (choosable) 2.75"*6.5" (choosable) 4"*6.5" (choosable) 4"*8" (choosable)
Pressure Display :	No
Auto Open:	No
Power(120volt)	700W/6.4Amps
Power(240volt)	700W/5Amps
Temperature Range :	Max.221" /430#

Heating Up Time (180)	15minutes
Time Range\$	0~999S
Machine Size (open size)	40% 31% 59cm
Packing Size:	46% 38% 35cm
Packing Weight:	15kg
Certificate:	FCC, CE

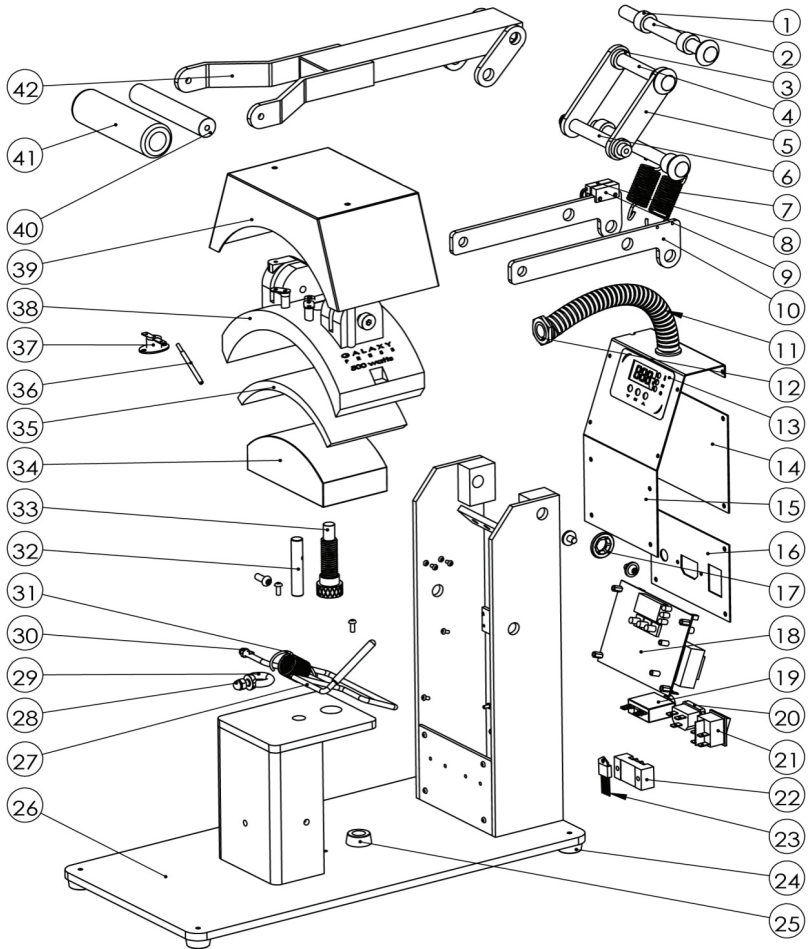

No.	Part Name(English)	Part No.	Qty.
1	washer	2000260	2
2	Steel pin	1600151	1
3	washer	2000589	4
4	Steel pin	1800147	3
5	Bridge link	1600091	2
	Bridge link	1600092	2
6	Thread pin	1300225	1
	Thread pin	1800580	1
7	spring	1600530	2
	spring	1600104	2
8	Magnet switch	1800614	1
9	magnet	1800615	1
10	Adjust arm	1600090	2
	Adjust arm	1600089	2
11	PP tube 0.13M	1800835	1
12	Tube connector	1800145	1
	Tube connector	1800135	1
13	Display overlay	1600233	1
	Display overlay	1600455	1
	Display overlay	1600456	1
14	Back cover 1	1600098	1
	Back cover 1	1600097	1
	Back cover 1	1600100	1
	Back cover 1	1600099	1
	Back cover 1	1600099	1
15	Control box	1600826	1
	Control	1600914	1
	Control	1600576	1
	Control	1600826	1
16	Back cover 2	1600831	1
	Back cover 2	1600096	1
	Back cover 2	1600095	1
	Back cover 2	1600094	1
17	!#\$%	1900390	6
	Hucap	1900391	6
18	Circuit board	1800355	1

19	Circuit breaker 8A	1800348	1
20	socket	1800344	1
21	On/off switch	1800346	1
22	Terminal block	1800345	1
23	Triac	1800951	1
24	! Foot Pad- XD2512-148	1800317	5
26	Machine base welded	1600401	1
	Machine base welded	1600400	1
27	Cap fix shell	1600359	1
28	Cap nut	1900930	1
	Cap nut	1900917	1
29	Spring hook base	1600718	1
30	Cap nut	1900923	1
31	spring	1600103	1
	spring	1600229	
32	Balance screw	1600223	
33	Pressure adjustment spindle	1600726	
34	Lower platen	1600572	1
	Lower platen	1600366	1
	Lower platen	1600367	1
	Lower platen	1600368	1
	Lower platen	1600369	1
35	Lower platen	1600363	1
36	Thermocouple	1800281	1
37	Thermosat	1800133	1
38	Heat platen	1600377	1
39	Heat platen cover	1600719	1
	Heat platen cover	1600720	1
	Heat platen cover	1600722	1
	Heat platen cover	1600721	1
40	Handle shaft	1300150	1
41	Foam grip	1300155	1
42	Handle welded	1600396	1
	Handle welded	1600424	1

WIRING SCHEMATIC

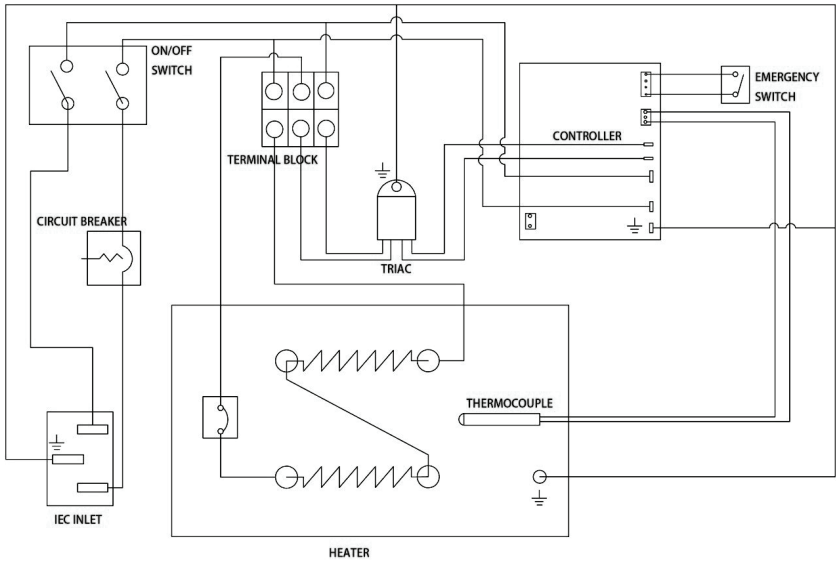

220V VERSION

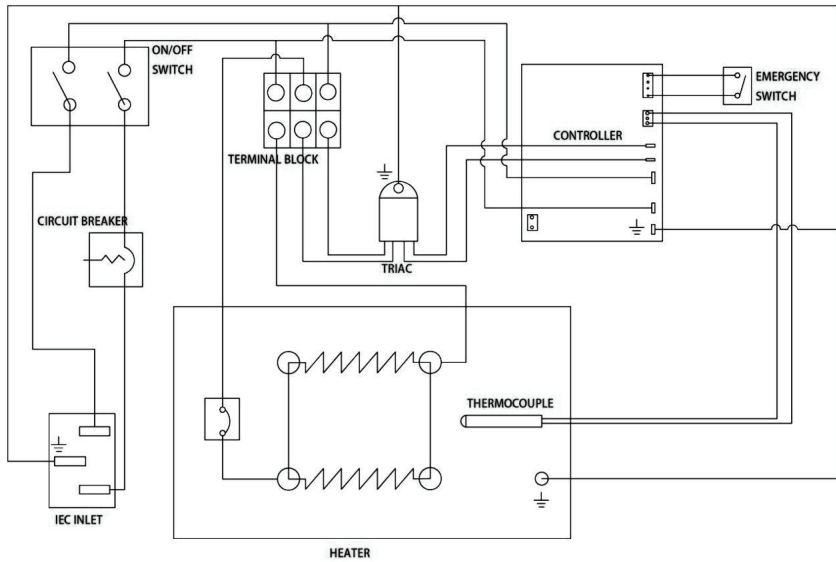

110V VERSION

TRANSPRO WARRANTY

Warranty Coverage

TransPro products offered by Pro World are warranted against defects in material and workmanship. Warranty is void if equipment has been damaged by accident, unreasonable use, neglect, unauthorized and/or improper service, or other causes not arising out of defects in material and workmanship. This warranty does not cover damage caused by normal wear and tear, neglect or lack of proper maintenance. This warranty is for the original purchaser/owner only, it is not transferable.

Warranty Duration

The heating element shall be warranted for the life of the heat press. There is a one (1) year warranty on major components, circuit boards and all other components.

Warranty Performance

During the warranty period, and in the event that a situation cannot be resolved by telephone/email and upon PRE-AUTHORIZATION from Pro World equipment must be shipped, freight prepaid to Pro World for service in the original packaging. After 30 days, all shipping and insurance expenses to and from Pro World of in-warranty equipment is solely the responsibility of the customer. Prior to 30 days the shipping costs will be refunded if Pro World deems the equipment to be defective as stated. Pro World cannot be held responsible for improper handling or any other damage incurred in transit. No charge will be made for labor and components for repair of in-warranty equipment. OUT-OF WARRANTY machines will be charged at the repair rates in effect at the time the machine is received.

Warranty Disclaimers

Pro World shall not be liable for loss of use of TransPro equipment or other incidental or consequential costs, expenses, or damages incurred by the original purchaser or any other user. The above warranty provisions constitute the entire agreement between all parties, and supersede any and all prior written and/or oral representations and understandings.

This "Limited Warranty" applies to all TransPro equipment. However, the procedure for obtaining service may vary outside the continental United States. Contact your Pro World representative for warranty information. The purchaser is responsible for compliance with all local laws, regulations and measure. Agreement shall be governed by and construed in accordance with all applicable laws of said region.



www.ProWorldInc.com

**Pro World Inc.
961 Bethel Ave.
Pennsauken, NJ 08110**

**Toll Free 800-678-8289
Outside U.S. 856-406-1020
Fax 856-406-1025**